

# SCHAFFER DIAPHRAGM PRESSURE GAUGE SSKE16-1

## APPLICATIONS

- Liquid & gaseous mediums
- Corrosive environments
- Oil & Gas applications
- Chemical & Petrochemical
- Food & Beverages
- Nuclear power plants

## FEATURES

- All SS measuring system
- Socket-case, direct welded
- Threaded / Flanged connection
- External zero adjustment



SCHAFFER DIAPHRAGM PRESSURE GAUGE, SSKE16-1

## DESCRIPTION

### General

**Design :** EN 837-3

**Accuracy :**  $\pm 1.6\%$  of full scale

**Ambient temperature :**  $-40 \dots +65^{\circ}\text{C}$

**Service temperature :**  $100^{\circ}\text{C}$  max.

**Pressure limits :** Steady pressure up to FS value  
Fluctuating pressure up to 90% of FS value

**Weld joints :** TIG argon arc welding

### Material of construction

**Sensing element :** Diaphragm

**Case & Ring material :** AISI 304 SS (Bayonet type)

**Top chamber :** AISI 304 SS -Machined Flange

**Diaphragm :** AISI 316 SS / Monel / Hastelloy C-276

**Bottom chamber :** AISI 304 SS / AISI 316 SS / Monel  
Hastelloy C-276-Machined Flange

**Movement mechanism :** Copper alloy

**Dial :** Aluminum, black graduation on white background

**Pointer :** Micro-adjustable, aluminum, black powder coated

**Gaskets, Blow-off disc & filling plug :** Neoprene / NBR

**Window :** Sheet glass / Shatterproof Safety Glass

**Option:** PTFE Lining

### Standard version

**Dial size :** DN100 / DN150

**Range :**  $-1 \dots 0 \dots 25$  bar [Standard] /  $60 \dots 600$  mbar [Low pressure]  
 $6 \dots 40$  mbar [Very low pressure]

**Mounting pattern :** Direct, Bottom connection

**Process connection :**  $\frac{1}{2}$ " NPT (M) /  $\frac{1}{2}$ " BSP (M)

**Ingress protection :** IP 54

**Execution :** Dry

### Filled versions

#### Glycerin

**Accuracy :**  $\pm 2.5\%$  of full scale

**Service temperature :**  $-20^{\circ}\text{C}$  up to  $65^{\circ}\text{C}$

**Ranges :**  $\geq 600$  mbar

**Dampening liquid :** Glycerin 99.7% / 80% / 60%

**Ranges :**  $\geq 100$  mbar

**Dampening liquid :** Glycerin + Water [20%+80%]

#### Temperature effect

When temperature of the measuring system deviates from reference temperature ( $+20^{\circ}\text{C}$ ) :

max error  $\pm 0.4\%$  / 10K of true scale value.

# SCHAFFER DIAPHRAGM PRESSURE GAUGE SSKE16-1

## DIMENSIONAL DRAWING

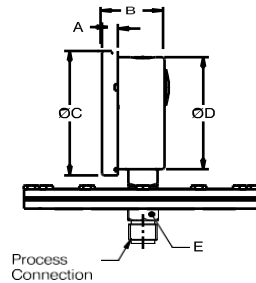
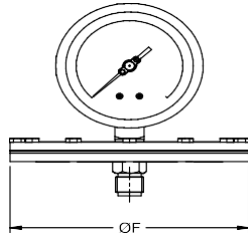

Range	DN	A	B	ØC	ØD	E	ØF	Weight (grams)
1 to 25 bar	100	12	48	111	100	A/F-22	98	1551
	150	15	48	161	149	A/F-22	98	1945

Range	DN	A	B	ØC	ØD	E	ØF	Weight (grams)
40 mbar to 600 mbar	100	12	48	111	100	A/F-22	150	2235
	150	15	48	161	149	A/F-22	150	2629

### NOTES

- Drawing not to scale. All dimensions are in mm.
- For other mounting details, Panel cut-out dimensions, kindly contact factory.

Range	DN	A	B	ØC	ØD	E	ØF	Weight (grams)
Below 40 mbar to 6 mbar	100	12	48	111	100	A/F-22	180	2914
	150	15	48	161	149	A/F-22	180	3308

## ORDERING CODES

<b>MODEL</b>	SSKE16-1 Schaffer Diaphragm Pressure Gauge				SSKE16-1
<b>DIAL SIZE</b>	<b>D4</b>	4" / 100 mm	<b>D6</b>	6" / 150 mm	D4
<b>MOUNTING</b>	<b>M1</b>	Direct bottom			M1
<b>CONNECTION</b>	<b>P04</b>	¼" NPT (M)	<b>P08</b>	½" NPT (M)	P08
	<b>P03</b>	¼" BSP (M)	<b>P05</b>	3/8" BSP (M)	
<b>CASE FILLING</b>	<b>F1</b>	Dry	<b>F3</b>	Glycerin filled	F1
	<b>F4</b>	Silicon oil filled			
<b>WETTED PARTS</b>	<b>S01</b>	AISI 304 SS	<b>S02</b>	AISI 316 SS	S01
	<b>S10</b>	Hastelloy C-276	<b>S05</b>	Monel	
<b>INGRESS PROTECTION</b>	<b>I1</b>	IP 65			I1
<b>RANGE</b>	<b>0-1 bar</b> Please mention range required with the measurement unit [SSKE offer in all types of National & International measurement units, e.g. kg/cm <sup>2</sup> , psi, kPa, etc. with single or dual scales]				0-1 bar
<b>OTHER OPTIONS</b>	<b>E16</b>	5 - point calibration certificate	<b>E31</b>	Custom designed dial	E16/E27
	<b>E28</b>	SS tag plate, AISI 316 SS	<b>E27</b>	SS tag plate, AISI 304 SS	
	<b>E20</b>	Cleaned for Oxygen service	<b>E10</b>	Over range protection 1.5xFS	
			<b>E32</b>	Dial tag marking	
			<b>E33</b>	AISI 316 SS case & ring	
			<b>S112</b>	PTFE Lining on flange	

Ordering Example : SSKE16-1-D4.M1.P08.F1.S01.I1/0-1 bar/E16/E27